

Disegno esploso
Exploded view

Bidone
Drum Cleaner

Emer
mod. Michelangelo Dry

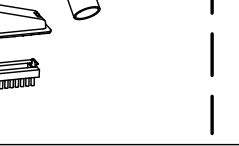
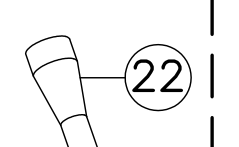
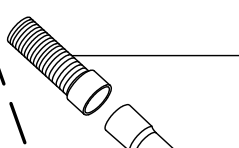
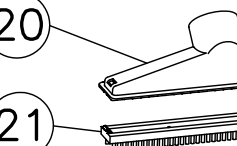
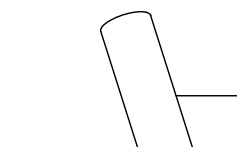
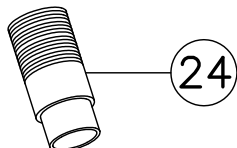
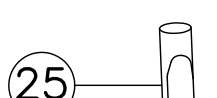
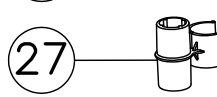
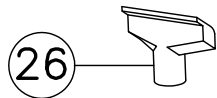
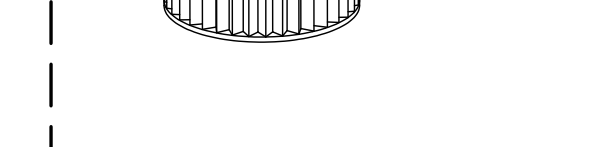
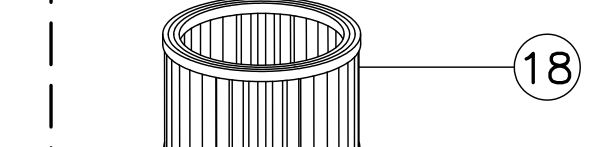
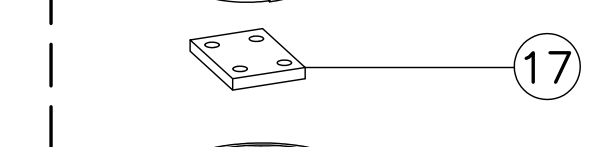
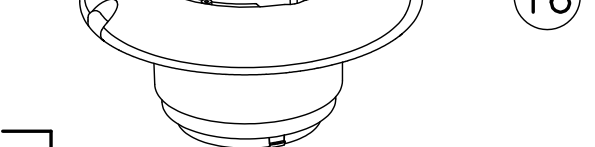
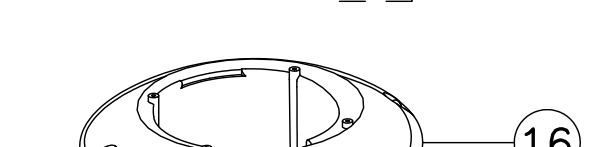
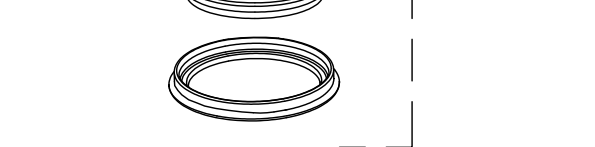
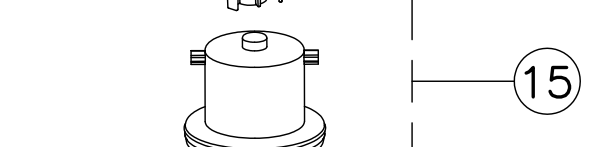
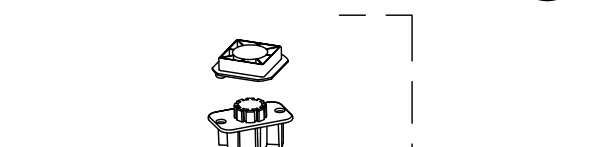
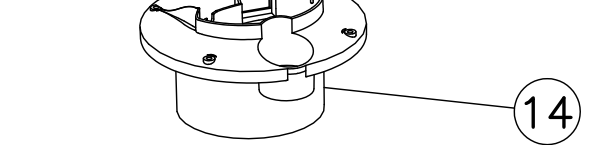
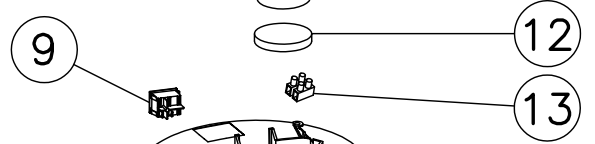
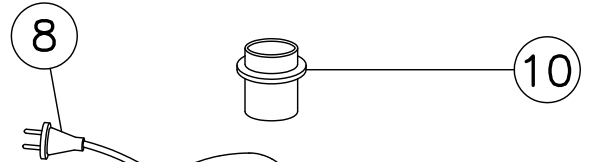
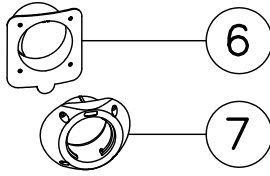
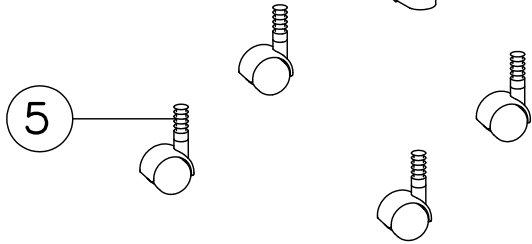
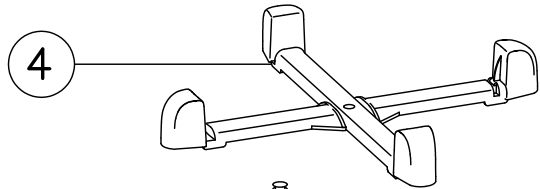
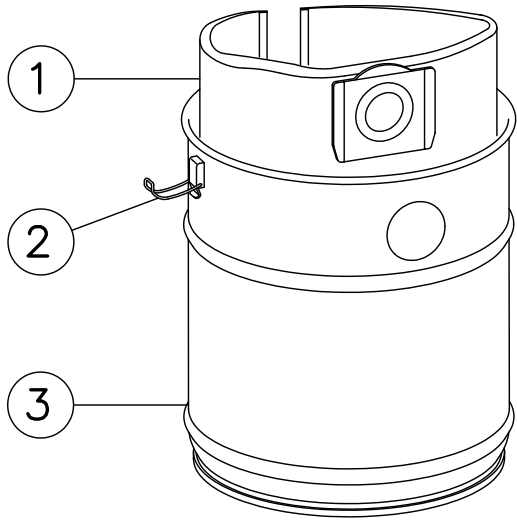

Ø32

Ø64

Lista Ricambi / Spare Parts list

Bidone / Vacuum Cleaner

Emer USA

MICHELANGELO DRY (MODELS 9020200, 9020201 & 9020205)

| Pos. | Descrizione | Description | Modello/Model | | | MAP |
|------|----------------------------|-----------------------------------|--------------------|--------------------|--------------------|--------|
| | | | BD 200 9020200U | BD 201 9020201U | BD 205 9020205U | |
| 1 | Sacco carta | Paper bag (not sold individually) | 110020 | 110020 | 110020 | - |
| 1 | Sacco carta | Paper bags (7 pk.) | 110020-7 | 110020-7 | 110020-7 | 21.99 |
| 2 | Gancio bidone (singolo) | Drum hinge (single) | 044701 | 044701 | 044701 | 2.78 |
| 3 | Fusto bidone | Drum | 04240051 | | 04240341 | 50.00 |
| 3 | Fusto bidone | Drum | - | 04250024 | - | 85.00 |
| 4 | Struttura carrello | Trolley frame | 0107156 | 0107156 | 0107156 | 8.02 |
| 5 | Ruota pivottante (singola) | Swivel wheel (single) | 142153 | 142153 | 142153 | 3.73 |
| 6 | Bocchettone aspirazione | Suction insert | 010740 | 010740 | 010740 | 3.73 |
| 7 | Deviatore | Shunter | 010745 | 010745 | 010745 | 3.73 |
| 8 | Cavo alimentazione | Cable set | 0800791 | 0800791 | 0800791 | 28.57 |
| 9 | Interruttore | Switch | 070006 | 070006 | 070006 | 4.84 |
| 10 | Raccordo soffiante | Blower insert | 010834 | 010834 | 010834 | 2.70 |
| 11 | Coperchio bidone | Coverlid | 010730 | 010730 | 010731 | 29.05 |
| 12 | Filtro uscita aria | Exhaust air grid | 020025 | 020025 | 020025 | 2.38 |
| 13 | Morsettiera | Connector | 070050 | 070050 | 070050 | 6.11 |
| 14 | Intermedio | Intermediate | 010710 | 010710 | 010710 | 16.11 |
| 15 | Assieme motore (*) | Motor set (*) | 0602071 | 0602671 | 0602071 | 119.05 |
| 16 | Supporto motore | Motor support | 010700 | 010700 | 010700 | 29.44 |
| 17 | Filtro motore | Motor filter | - | - | - | - |
| 18 | Cartuccia filtro carta | Paper cartidge filter | 020140 | 020140 | 020140 | 20.24 |
| 19 | Tubo Ø 32 (singolo) | Tube Ø 32 (single) | 050050 | 050050 | 050050 | 5.36 |
| 19 | Tubo Ø 64 (singolo) | Tube Ø 64 (single) | - | - | 050055 | 9.00 |

Lista Ricambi / Spare Parts list

Bidone / Vacuum Cleaner

Emer USA

MICHELANGELO DRY (MODELS 9020200, 9020201 & 9020205)

| Pos. | Descrizione | Description | Modello/Model | | | MAP |
|------|-----------------------|-----------------------|--------------------|--------------------|--------------------|-------|
| | | | BD 200 9020200U | BD 201 9020201U | BD 205 9020205U | |
| 20 | Spazzola Ø 32 | Nozzle Ø 32 | 130143 | 130143 | 130143 | 11.03 |
| 20 | Spazzola Ø 64 | Nozzle Ø 64 | - | - | 130140 | 11.03 |
| 21 | Accessorio pavimenti | Hard floors accessory | - | 130152 | 130141 | 12.30 |
| 22 | Soffiante bidone Ø 64 | Blower Ø 64 | - | - | 010747 | 1.90 |
| 23 | Impugnatura Ø 32 | Handle Ø 32 | 010104 | 010104 | 010104 | 15.31 |
| 23 | Impugnatura Ø 64 | Handle Ø 64 | - | 010750 | 010750 | 13.41 |
| 24 | Tubo flessibile Ø 32 | Flexible hose Ø 32 | 0500111 | 0500111 | 0500111 | 19.05 |
| 24 | Tubo flessibile Ø 64 | Flexible hose Ø 64 | - | - | 050015 | 19.05 |
| 25 | Lancia Ø 32 | Crevice tool Ø 32 | 130001 | 130001 | 130001 | 3.57 |
| 25 | Lancia Ø 64 | Crevice tool Ø 64 | - | - | 130080 | 5.00 |
| 26 | Bocchetta Ø32 | Upholstery Ø 32 | 130005 | 130005 | 130005 | 5.00 |
| 27 | Portaccessori | Accessories Support | 012138 | 012138 | 012138 | 3.57 |
| - | Imballo | Packaging box | 1001561 | 1001561 | 1001561 | 11.90 |
| - | Manuale istruzioni | Instruction book | 1200622 | 1200625 | 1200622 | 3.81 |